

Power Solution for Your Better Tomorrow



# General Machinery Selector Sheets

- ✓ Mini Excavators
- ✓ Skid Steer Loader



✉ [sales@tidepower.uk](mailto:sales@tidepower.uk) | [www.tidepower.uk](http://www.tidepower.uk)

**WORLDWIDE OFFICE:** CHINA, VIETNAM, MALAYSIA, AUSTRALIA  
COLOMBIA, EGYPT, SAUDI ARABIA, MYANMAR, UAE, NIGERIA.

Descriptions and specification are substantially correct at time of printing and subject to change without notice. (Version no.: V2505)

Global Energy Solutions Partner



## Model TD10

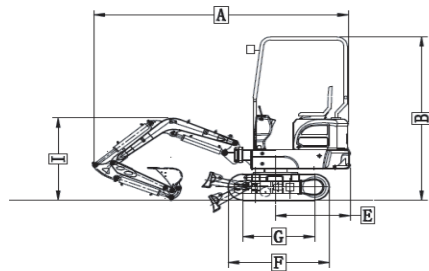

### OVERALL DIMENSIONS

A Overall Length	2780mm
B Overall Height	2150mm
C Overall Width	930mm
D Width of Track	180mm
E Min. Tail Turning Radius	883mm
F Length of Track	1195mm
G Tumbler Distance	845mm
H Min. Ground Clearance	150mm
I Min. Boom Height	1107mm
J Width of Platform	800mm
K Ground Clearance to Upperstructure	430mm

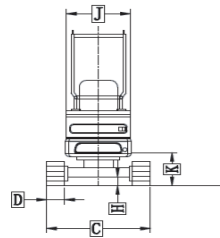

### PERFORMANCE AND SPECIFICATION

Engine Model	Koop 192F Air-Cooled
Power	7.6kw / 3000rpm
Working Pressure	16Mpa
Max. Digging Force	6.5Kn
Gradeability	25°
Ground Contact Pressure	35Kpa
Travel Speed	2.1km / h
Pump Capacity	21.6(l / min)
Turning Speed	13rpm / min
Bucket Capacity	0.025m <sup>3</sup>
Boom Swing Angle	42° L / 62° R
Overall Weight	1013kg

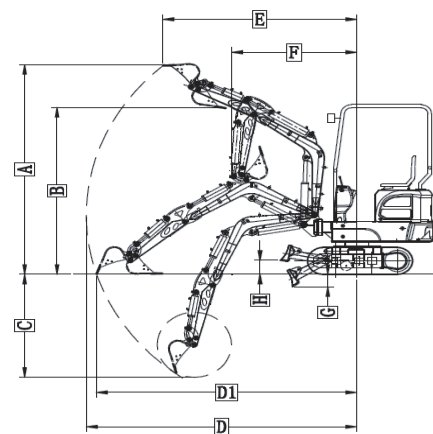

### PERFORMANCE AND SPECIFICATION

a Max. Digging Height	2637mm (2930mm Dozer Blade)
b Max. Dumping Height	2170mm
c Max. Vertical Digging Depth	1336mm ( 1552mm Dozer Blade)
d Max. Digging Radius	3300mm
d1 Max. Digging Radius at Ground	3072mm
e Digging Radius of Max. Digging Height	2200mm
f Min. Turning Radius	1425mm
g Lowest Position Dozer Blade	170mm
h Highest Position Dozer Blade	185mm



## Model TD12

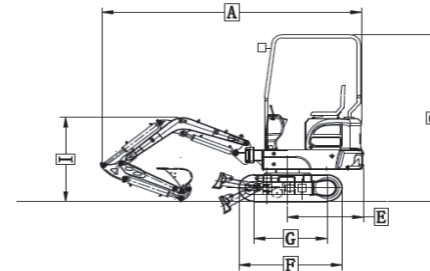

### OVERALL DIMENSIONS

A Overall Length	2780mm
B Overall Height	2150mm
C Overall Width	930mm
D Width of Track	180mm
E Min. Tail Turning Radius	883mm
F Length of Track	1195mm
G Tumbler Distance	845mm
H Min. Ground Clearance	150mm
I Min. Boom Height	1107mm
J Width of Platform	800mm
K Ground Clearance to Upperstructure	430mm

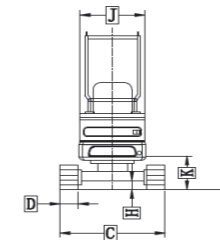

### PERFORMANCE AND SPECIFICATION

Engine Model	Kubota D722-EF11
Power	10.2kw / 2500rpm
Working Pressure	16Mpa
Max. Digging Force	6.5Kn
Gradeability	25°
Ground Contact Pressure	35Kpa
Travel Speed	2.1km / h
Pump Capacity	25 (l / min)
Turning Speed	13rpm / min
Bucket Capacity	0.025m <sup>3</sup>
Boom Swing Angle	42° L / 62° R
Overall Weight	1035KG

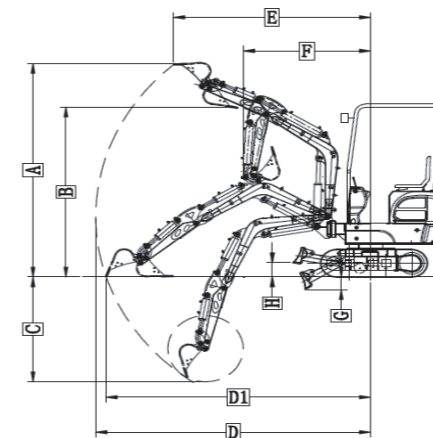

### PERFORMANCE AND SPECIFICATION

a Max. Digging Height	2637mm(2930mm Dozer Blade)
b Max. Dumping Height	2170mm
c Max. Vertical Digging Depth	1336mm(1552mm Dozer Blade)
d Max. Digging Radius	3300mm
d1 Max. Digging Radius at Ground	3072mm
e Digging Radius of Max. Digging Height	2200mm
f Min. Turning Radius	1425mm



## Model TD15

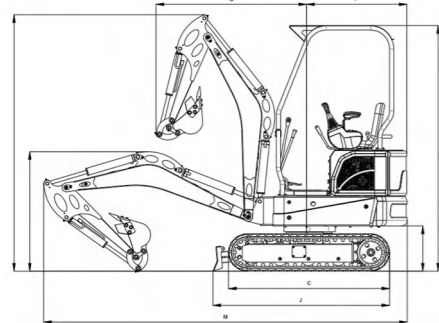

### OVERALL DIMENSIONS

A Track shoe width	180 / 230mm
B Track width	1100mm
C Track length	1454mm
D Overall width of platform	980mm
Height of driving canopy	2200mm
F Rear turning radius	910mm
G Minimum turning radius of front end	1360mm
H Rear end height from ground	410mm
I Minimum ground clearance of chassis	170mm
J Lower machine length	1600mm
K Bulldozer blade height	220mm
L Bulldozer blade width	1160mm
M and length	3280mm
N Lifting height of big end of bucket arm	2320mm
Boom height	1080mm

### PERFORMANCE AND SPECIFICATION

Engine Model	Laidong 3TE20-G13A / Yanmar 3TNV70
Power	14.8KW / 2200rpm
Work Pressure	16MPa
Maximum digging force of bucket	6.5KN
Climbing grade	30°
Ground pressure	35KPa
Walking speed	1.6KM / h
Main pump flow	25L / Min
Platform rotation speed	11.5rpm / min
Bucket capacity	0.03m <sup>3</sup>
Machine weight	1350KG

### PERFORMANCE AND SPECIFICATION

a Maximum Digging Height	3320mm
b Maximum Dumping Height	2550mm
c Maximum Digging Depth	1990mm
d Maximum Digging Radius	3450mm
e Maximum Digging Reachat Ground Level	3320mm
g Minimum Turning Radius	1230mm

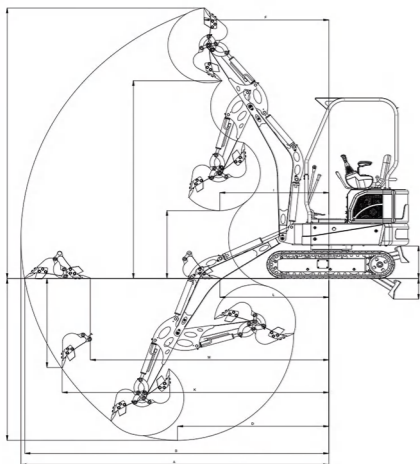

## Model TD18

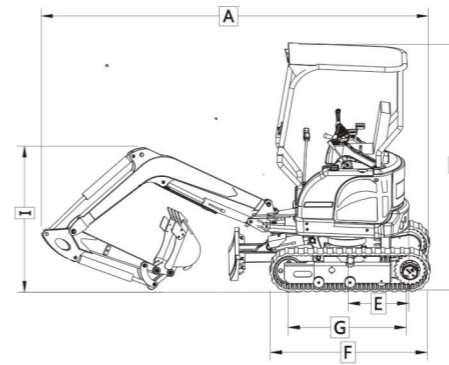

### OVERALL DIMENSIONS

A Overall Length	2920mm
B Overall Height	2200mm
C Overall Width	1100mm
D Width of Track	230mm
E Min. Tail Turning Radius	790mm
F Length of Track	1410mm
G Tumbler Distance	1045mm
H Min. Ground Clearance	200mm
I Min. Boom Height	1205mm
J Width of Platform	970mm
K Ground Clearance to Upperstructure	440mm

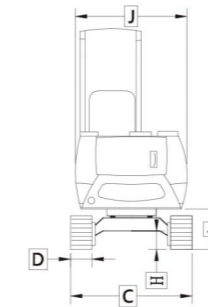

### PERFORMANCE AND SPECIFICATION

Engine Model	Perkins 403D-11
Power	14.7kw / 2200rpm
Working Pressure	18Mpa
Max. Digging Force	12Kn
Gradeability	30°
Ground Contact Pressure	32Kpa
Travel Speed	2.7km / h
Maximum Hauling Force	15Kn
Turning Speed	13rpm / min

### PERFORMANCE AND SPECIFICATION

a Max. Digging Height	3400mm
b Max. Dumping Height	2250mm
c Max. Vertical Digging Depth	2042mm
d Max. Digging Radius	3300mm
d1 Max. Digging Radius at Ground	3600mm
e Digging Radius of Max. Digging Height	2450mm
f Min. Turning Radius	1550mm

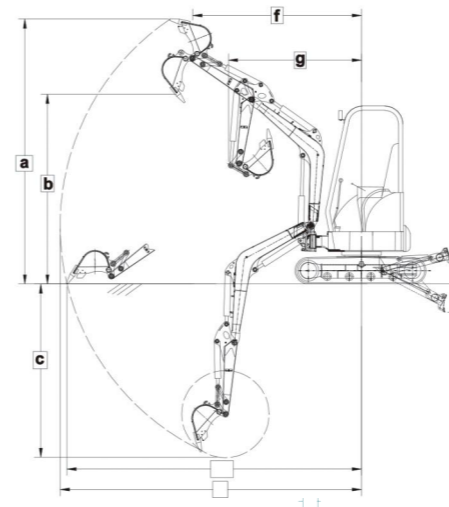



## Model TD20

### OVERALL DIMENSIONS

A Maximum length of Transportation	3410mm
B Machine Height	2250mm
C Overall width	980 / 1300mm
D Width of track	230mm
E Platform Tail Turning Radius	710mm
F Length of track	1540mm
G Sprocket to idler centres	1195mm
H Between under carriage and ground	200mm
I Between boom and ground	1150mm
J Width of platform	970mm
L Between platform and ground	470mm
20FT Loading	4 sets
40GP Loading	8 Sets

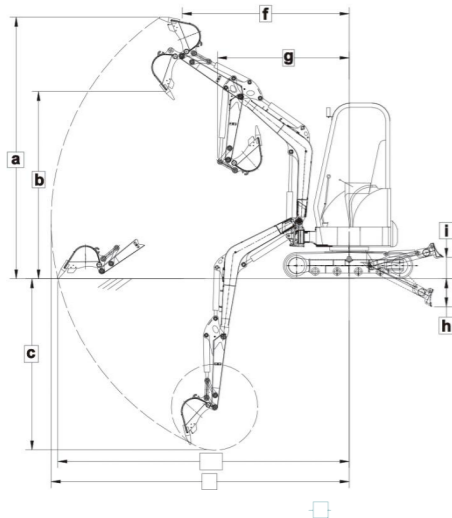
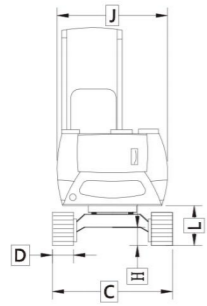
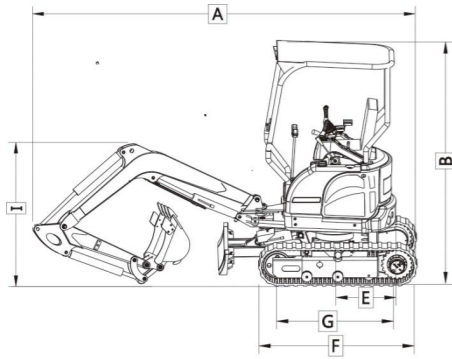

### PERFORMANCE AND SPECIFICATION

Engine Model	Perkins(CAT)403J-11 / Yanmar 3TNV70
Power	14.7Kw / 2200rpm
Operation hydraulic pressure	18MPa
Pump	39L / min
Maximum Digging Force	16KN
Gradeability	58%(30°)
Pressure to the ground	27KPa
Walking Speed	Low 1.3 Km / h High 2.6Km / h
Swing Speed to platform	10.5rpm
Bucket Capacity	0.055m <sup>3</sup>
Bucket Width	450mm
Boom Swing	42° L / 62° R
Overall Weight	1926KG

### PERFORMANCE AND SPECIFICATION

a Maximum Digging Height	3320mm
b Maximum Dumping Height	2550mm
c Maximum Digging Depth	1990mm
d Maximum Digging Radius	3450mm
e Maximum Digging Reachat Ground Level	3320mm
g Minimum Turning Radius	1230mm



## Model TD25

### OVERALL DIMENSIONS

A Maximum length of Transportation	3870mm
B Machine Height	2360mm
C Overall width	1420mm(Steel Track)
D Width of track	250mm
E Platform Tail Turning Radius	645mm
F Length of track	1895mm
G Sprocket to idler centres	1510mm
H Between under carriage and ground	250mm
I Between boom and ground	1340mm
J Width of platform	1350mm
L Between platform and ground	480mm
20FT Loading	2Sets
40GP Loading	4Sets

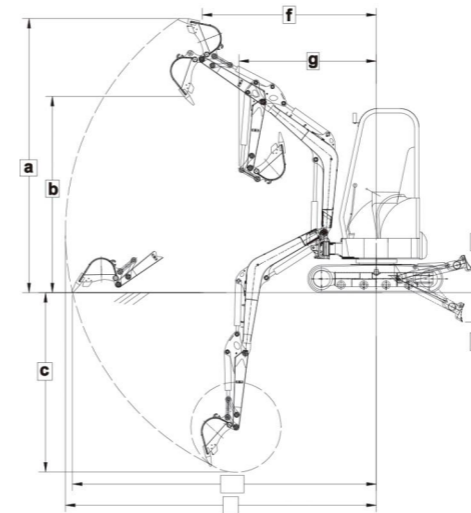
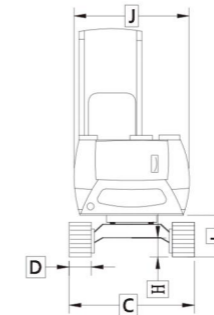
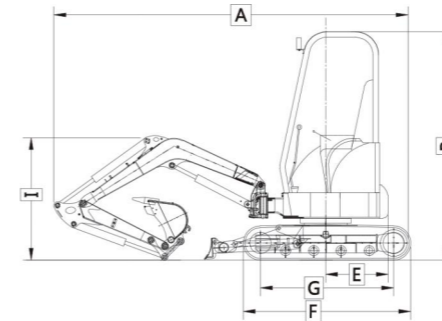

### PERFORMANCE AND SPECIFICATION

Engine Model	Perkins(CAT)403J-11 / Yanmar 3 TNV80
Power	14.7Kw / 2200rpm
Operation hydraulic pressure	21MPa
Pump	60.8L / min
Maximum Digging Force	17.6KN
Gradeability	30°
Pressure to the ground	26KPa
Walking Speed	Low 2.3Km / h High 4.1Km / h
Swing Speed to platform	13rpm
Bucket Capacity	0.08m <sup>3</sup>
Bucket Width	500mm
Boom Swing	45° L / 78° R
Overall Weight	2310KG

### PERFORMANCE AND SPECIFICATION

a Maximum Digging Height	3744mm ( 4335mm )
b Maximum Dumping Height	2670mm
c Maximum Digging Depth	2200mm ( 2486mm )
d Maximum Digging Radius	4155mm
e Maximum Digging Reachat Ground Level	4040mm
g Minimum Turning Radius	1778mm



## Model TD30

### OVERALL DIMENSIONS

A Maximum length of Transportation	4010mm
B Machine Height	2360mm
C Overall width	1540mm(Steel Track)
D Width of track	250mm
E Platform Tail Turning Radius	710mm
F Length of track	1895mm
G Sprocket to idler centres	1510mm
H Between under carriage and ground	250mm
I Between boom and ground	1380mm
J Width of platform	1350mm
L Between platform and ground	480mm
20FT Loading	2Sets
40GP Loading	4Sets

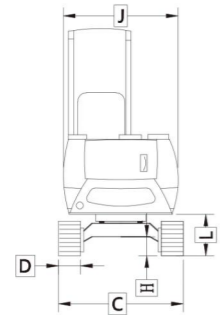
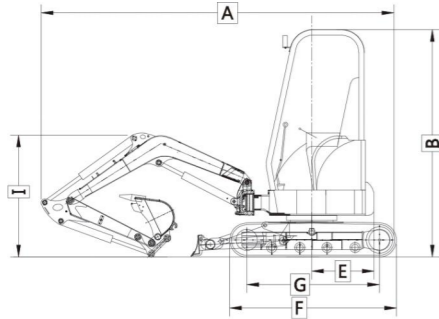

### PERFORMANCE AND SPECIFICATION

Engine Model	Perkins(CAT)403J-11 / Yanmar 3 TNV80
Power	14.7Kw/2200rpm
Operation hydraulic pressure	21MPa
Pump	60.8L/min
Maximum Digging Force	18.2KN
Gradeability	30°
Pressure to the ground	26KPa
Walking Speed	Low2.3Km/h High4.1Km/h
Swing Speed to platform	13rpm
Bucket Capacity	0.09m <sup>3</sup>
Bucket Width	550mm
Boom Swing	45° L / 78° R
Overall Weight	2650KG

### PERFORMANCE AND SPECIFICATION

a Maximum Digging Height	3865mm ( 4510mm )
b Maximum Dumping Height	2760mm
c Maximum Digging Depth	2580mm ( 2810mm )
d Maximum Digging Radius	4375mm
e Maximum Digging Reachat Ground Level	4275mm
g Minimum Turning Radius	1935mm

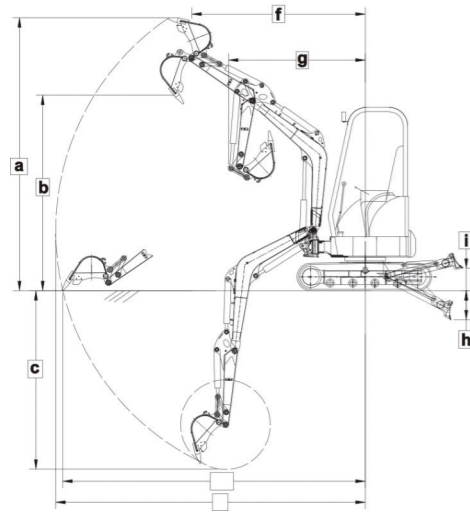

## Skid Steer Loader

### Performance Parameter

Model	TPW30	TPW40	TPW45	TPW60	TPW65
Operating load (kg)	300	500	700	800	1050
Max Speed (km/h)	9	10	12	12	12
Rated flux (L/min)	50	60	62.5	62.5	75
High Flow Flux (L/min)	/	/	/	/	120
Tire (track) model	23×8.5-15	8.5-15	10-16.5	12-16.5	12-16.5
Rated power (Kw)	18.4	37	37	45	55
Fuel tank capacity (L)	25	60	70	80	75
Self weight (kg)	1500	2300	2700	2800	3500
Bucket capacity (m)	0.2	0.3	0.41	0.4	0.5

### Size Parameter

Model	TPW30	TPW40	TPW45	TPW60	TPW65
A. Overall operating height (mm)	3590	3300	3980	4000	4070
B. Height to bucket hinge pin (mm)	2650	2725	3080	3100	3280
C. Height to top of cab (mm)	2050	2000	2140	2160	2160
D. Height to bottom of level bucket(mm)	2470	2558	2913	2983	3140
E. Without bucket length (mm)	2430	2300	2640	2750	2880
F. Overall length with bucket(mm)	3170	2950	3420	3490	3580
G. Dumping angle at maximum height(°)	40	40	40	40	40
H. Dumping height(mm)	1920	2050	2380	2400	2500
I. Dumping reach(mm)	720	790	700	750	700
J. Rollback o bucket on ground(°)	30	30	30	30	30
K. Rollback of bucket at full height(°)	104	104	104	104	104
L. Wheelbase(mm)	801	897	991	991	1080
M. Ground clearance(mm)	180	140	185	205	205
N. Angle of departure(°)	20	20	20	20	20
O. Front turning radius without bucket(mm)	971	1098	1168	1198	1250
P. Front tuning radius(mm)	1681	1760	1958	1958	2112
Q. Rear tuning radius(mm)	1371	1296	1630	1728	1774
R. Rear axle to bumper (mm)	940	964	1108	1208	1082
S. Tread width (mm)	882	1080	1450	1500	1500
T. Width (mm)	1110	1350	1720	1880	1880
U. Bucket width (mm)	1150	1400	1740	1880	1880



**Performance Parameter**

Model	TPW100	TPW120	TPT50	TPT65	TPT100
Operating load (kg)	1100	1200	700	1000	1200
Max Speed (km/h)	9\18	9\18	10	12	9\18
Rated flux (L/min)	75	75	60	80	88
High Flow Flux (L/min)	140	140	/	120	140
Tire (track) model	12-16.5	12-16.5	300×52.5	320X86	320X86
Rated power (Kw)	74	103	36	55	74
Fuel tank capacity (L)	90	90	50	90	90
Self weight (kg)	3550	3600	2800	3800	4500
Bucket capacity (m)	0.55	0.55	0.31	0.5	0.55

**Size Parameter**

Model	TPW100	TPW120	TPT50	TPT65	TPT100
A. Overall operating height (mm)	4070	4070	3350	3480	4070
B. Height to bucket hinge pin (mm)	3280	3280	2770	2900	3280
C. Height to top of cab (mm)	2160	2160	2050	2150	2160
D. Height to bottom of level bucket(mm)	3140	3140	2603	2730	3140
E.Without bucket length (mm)	2880	2880	2300	2750	3000
F. Overall length with bucket(mm)	3580	3580	2950	3500	3700
G. Dumping angle at maximum height(°)	40	40	40	40	40
H.Dumping height(mm)	2500	2500	2100	2230	2500
I. Dumping reach(mm)	700	700	790	715	700
J. Rollback o bucket on ground(°)	30	30	30	30	30
K.Rollback of bucket at full height(°)	104	104	104	104	104
L. Wheelbase(mm)	1115	1115	1240	1500	1500
M. Ground clearance(mm)	205	205	140	200	200
N. Angle of departure(°)	20	20	20	20	20
O. Front turning radius without bucket(mm)	1278	1278	1064	1298	1365
P. Front tuning radius(mm)	2144	2144	1825	2010	2200
Q. Rear tuning radius(mm)	1857	1857	1264	1714	1742
R.Rear axle to bumper (mm)	1082	1082	594	890	938
S.Tread width (mm)	1500	1500	1102	1462	1654
T.Width (mm)	1880	1880	1402	1782	1994
U.Bucket width (mm)	1880	1880	1500	1830	2030

The entire series is from TPW30-TPT120, with a operating load ranging from 300-1500kg, from radial lifting to vertical lifting, and from wheeled to tracked.d



**Performance Parameter**

Model	TPT120	TPW35D	TPW50D
Operating load (kg)	1500	500	850
Max Speed (km/h)	9\18	6	6
Rated flux (L/min)	88	60	75
High Flow Flux (L/min)	140	/	/
Tire (track) model	450 X86	28*9-15	28*9-15
Rated power (Kw)	103	37	45
Fuel tank capacity (L)	90	60	80
Self weight (kg)	4800	2300	2800
Bucket capacity (m)	0.6	0.3	0.4

**Size Parameter**

Model	TPT120	TPW35D	TPW50D
A. Overall operating height (mm)	4070	3310	3770
B. Height to bucket hinge pin (mm)	3280	2320	2810
C. Height to top of cab (mm)	2160	1500	1600
D. Height to bottom of level bucket(mm)	3140	2160	2643
E.Without bucket length (mm)	3000	2400	2800
F. Overall length with bucket(mm)	3700	3150	3490
G. Dumping angle at maximum height(°)	40	40	40
H.Dumping height(mm)	2500	1550	2080
I. Dumping reach(mm)	700	660	700
J. Rollback o bucket on ground(°)	30	30	30
K.Rollback of bucket at full height(°)	104	104	104
L. Wheelbase(mm)	1500	897	991
M. Ground clearance(mm)	200	150	205
N. Angle of departure(°)	20	20	20
O. Front turning radius without bucket(mm)	1365	1098	1228
P. Front tuning radius(mm)	2200	1760	2010
Q. Rear tuning radius(mm)	1742	1296	1746
R.Rear axle to bumper (mm)	938	964	1208
S.Tread width (mm)	1654	1080	1450
T.Width (mm)	2124	1380	1720
U.Bucket width (mm)	2160	1400	1740

